

motorized

EXTERIOR FRT SHADE

FABRIC RETENTION TRACK



FRT STANDARD/HEAVY DUTY INSTALLATION INSTRUCTIONS

TOOLS NEEDED

INSTALLATION

TOOLS FOR ASSEMBLY

- Drill
- $\frac{3}{8}$ " Metal Drill Bit
- $\frac{1}{4}$ " Masonry Drill Bit
- Measuring Tape
- Pencil
- 4' - 6' Level
- Phillips #2 Driver
- Manual Screwdriver (Phillips)
- Driver for mounting fasteners
- Rubber Mallet

HARDWARE PROVIDED (PER SHADE)

- End Caps (2)
- Top Back of Box Piece
- Box Hood
- FRT Tracks (2)
- Remote (1)
- Motor Clip (1)
- "L" Channel Brackets for inside mount (2) if ordered
- Idler clip/Cotter pin

NOTE: Hardware needed

- $\frac{5}{16}$ " X 4 $\frac{1}{2}$ " Torx Screws or Appropriate (4 per shade)
- $\frac{3}{8}$ " Flat Washers or Appropriate (4 per shade)
- 2 $\frac{1}{2}$ " Wood screws (6-8) or Appropriate
- $\frac{3}{4}$ " Sheet metal screws (6-8)
(For optional "L" channel mounting bracket)

COMPONENTS

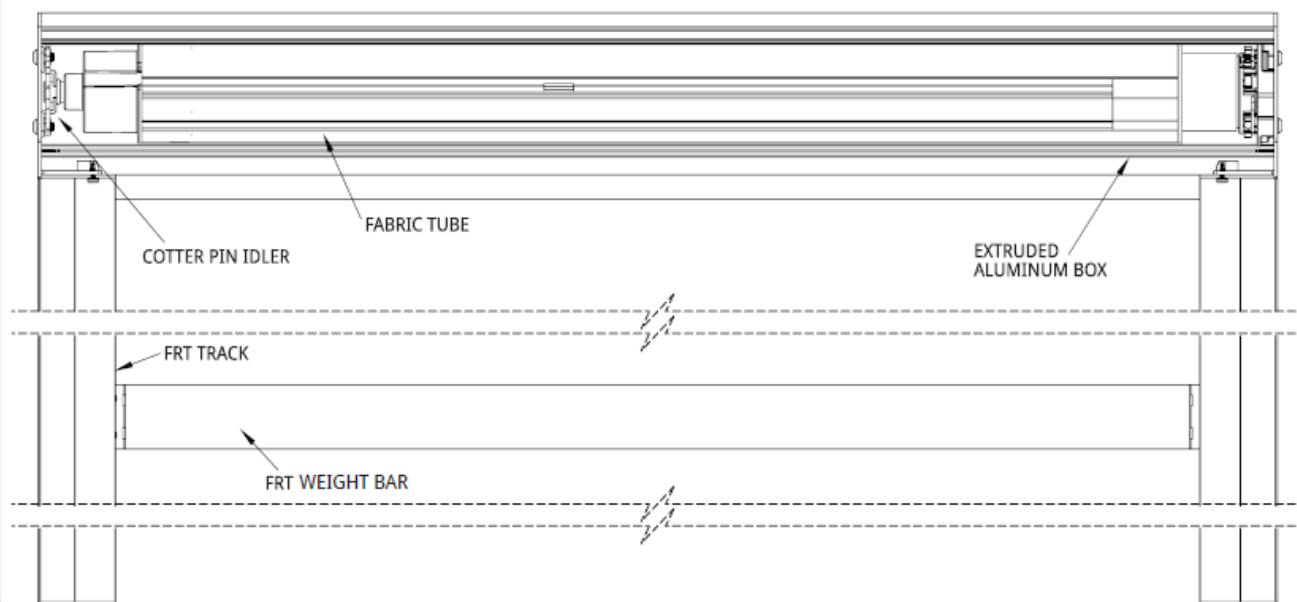

STEP 1

SHADE COMPONENTS

PREPARE BACK OF BOX

a. Mounting holes on box should be evenly spaced and marked at 2" from each end.

b. Drill 2 mounting holes using a $\frac{3}{8}$ " metal drill.

c. Repeat on opposite side.



d. Use screws installed in the top back box piece to install end caps on top back box piece.

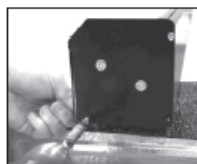
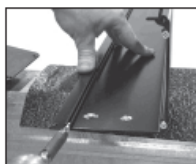

Before you begin Remove parts from packaging

! If your installation requires "L" channel, refer to "**L" Channel Installation** on page "6" before preparing back of box.

! INFORMATION

! Due to the nature of these products, mounting procedures may vary. On-site adjustments to these instructions may be required to achieve optimal installation.

! These instructions represent a Surface mount installation.

! Surface mount holes are drilled on the back of the top back box piece and Under mount holes are drilled on the top of the top back box piece.

NOTE:

! 2 person job

HANG BACK OF BOX

a. Hold top back box piece to surface, drill holes and secure lag screw with washer in top hole.

b. Level top back box piece.

c. Once top back box piece is secure, bolt 2 bottom lags and washers on each side.



d. Remove and set aside hood screws under end caps on both sides.

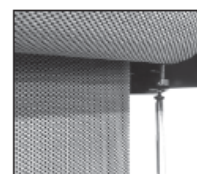

! INFORMATION

Be sure mounting bolts will not interfere with fabric operation.

STEP 2

SHADE COMPONENTS CONT.

INSTALL FABRIC TUBE

- Remove cotter pin from non-operation end.
- Insert fabric tube into end caps, operation side first.
- Place pin idler into cradle.
Reinstall cotter pin to lock into place.

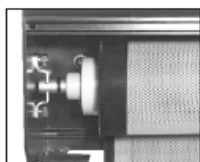
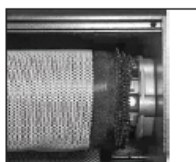

NOTE:

- ⚠ 2 person job
- ⚠ Consider the routing of the power cord at this time

- Ensure the fabric tube is completely secure in its brackets inside of the box.



STEP 3

SIDE TRACK INSTALLATION

MEASURING / CUTTING THE SIDE TRACKS

- To determine track cut length, measure from the bottom of the box to the desired drop.
- Side tracks must be cut from the bottom end. You will need to remove bottom cap before cutting track.
- Verify you allowed for thickness of bottom cap in your deductions.
- Cut side track to desired height with insert and track cover in place.

⚠ INFORMATION

Before cutting track, identify right and left track.
Side tracks and "L" channels are shipped over length and require to be cut down during installation.



- From the full length of the cut side track, slide out snap-in track cover.
- Mark the left piece L and right piece R. These will be reinstalled later.
- Remove burrs from the bottom of the cut side track and install the bottom end cap.

STEP 4

SIDE TRACK INSTALLATION

INSTALL FABRIC INTO SIDE TRACK

Before you begin

- ❗ Lower screen until the weight bar hangs at least 5" from the bottom most portion of the box.

- Insert fabric into side track and align outside of track with outside of box. Attach with top fastener only.
- Repeat with opposite track.
- Check that tracks are leveled and install bottom fastener to secure track.

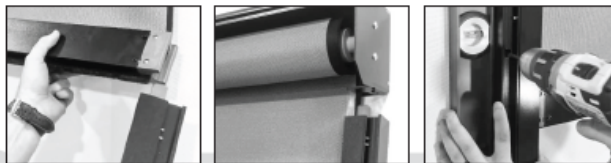

- Add additional fasteners as needed, checking continually to make sure no binding has occurred.

Install fasteners in additional pre-drilled holes.

NOTE:

- ❗ After installing bottom fastener, if binding occurs while fabric is going down, loosen bottom fastener and allow fabric to correct itself.



- Install the track cover working from top to bottom (making sure you have the correct cover for each side track). You may use a rubber mallet to tap track cover in place.

STEP 5

SHADE COMPONENTS CONT

INSTALL BOX HOOD

- Set the box hood into groove on the top of the top back piece of the box and hinge to set into place.
- Use the 2 hood screws removed from the end caps on the top back box piece to secure box hood.

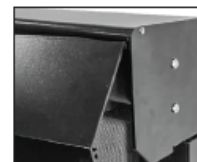

ENJOY THE SHADE

OPTIONAL "L" CHANNEL

"L" CHANNEL INSTALLATION

! INFORMATION

Do NOT attach side tracks to structure at this time. "L" Channels are shipped over length and require to be cut down during installation.

INSTALL "L" CHANNEL

- If using the optional "L" channel, cut to full height of opening at this point.

NOTE:

- ! It is recommended you pre-drill the "L" channel prior to installing.



- The back of the "L" channel will be lined up with the back of the box.



- Install the top mounting fastener, level the "L" channel and install the bottom fastener.



- Add additional fasteners as needed approx. 1 fastener every 2 feet.
- Proceed to Prepare Back of Box. (Page 3)

INSTALL FABRIC INTO SIDE TRACK WITH "L" CHANNEL

Before you begin

- ! Remove track covers and set aside



- Insert fabric into side track and align outside of track with outside of box. Attach with top fastener only.



- Repeat with opposite track.



- Check that the tracks are leveled.

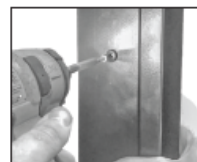

- Install bottom fastener to secure track.

- Install the track cover working from top to bottom.



Make sure you have the correct cover for each side.



NOTE:

- ! If after installing bottom fastener and binding occurs while fabric is going down, loosen bottom fastener and allow fabric to correct itself.



MOTORIZED OPTION

ADJUSTING MOTOR LIMITS

PREMIUM LIMIT SETTINGS

Before you begin

- ! Use paper clip to activate limit settings. Red light will briefly flash. Motor will make a brief jog.

SETTING TOP LIMIT

- Press and hold up button to desired position.
- Press and hold STOP button to set top limit. Motor will make a brief jog.



SETTING BOTTOM LIMIT

- Press and hold bottom button to desired position.
- Press and hold STOP button to set bottom limit. Motor will make a brief jog.



Remote is no longer in Limit Programming Mode. Limits are now set.

SOMFY LIMIT SETTINGS

SETTING TOP LIMIT

- Send motor to its current upper limit.
- Press both  and  buttons at the same time until motor jogs.
- Adjust to new upper limit position.
- Press  button until the motor jogs.

SETTING LOWER LIMIT

- Send motor to its current lower limit.
- Press both  and  buttons at the same time until motor jogs.
- Adjust to new lower limit position.
- Press  button until the motor jogs.

ENJOY THE SHADE

